

# MAXIMAL FORKLIFT SPECIFICATION

## M series 1.3-2.0t Electric Three-wheel Forklift Specification

1		Model		FB13S-MQJZ2	FB13S-MQJD2	FB16S-MQJZ2	FB16S-MQJD2	FB18S-MQJZ2	FB18S-MQJD2	FB20S-MQJZ2	FB20S-MQJD2		
Specification	2	Rated capacity	kg	1300		1600		1800		2000			
	3	Load centre	mm	500									
	4	Lifting height	mm	3000									
	5	Free lifting height	mm	120									
	6	Fork size	T×W×L	40×100×920									
	7	Tilting angle	F/R (α°/β°)	6.5°/6.5°									
	Dimensions	8	Overall Dimension	Length (to fork face)	mm	1790	2007		2007		2122		
9		Width		mm	1070	1070		1070		1140			
10		Height when mast lowered		mm	1975	1975		1975		1975			
11		Height when mast extended		mm	4010	4010		4010		4010			
12		Height to safeguard		mm	1960								
13		Turning radius	Min.	mm	1435	1545		1545		1655			
14		Overhang	mm	365									
15/16		Tread(Front/Rear)	mm	910/180	910/180		910/180		925/180				
17		Ground clearance	Min.	mm	90								
18		Wheelbase	mm	1300	1400		1400		1515				
19		Fork spread	Min./Max.	mm	200/970								
20		Working aisle width with pallet (Ast)*	1000×1200 crossways	mm	3160	3270		3270		3380			
21			800×1200 lengthways	mm	3260	3370		3370		3480			
Performance		22	Speed	Travel (Laden)	km/h	13	14	13	14	13	14	13	13
	23	Travel (Unladed)		km/h	13	14	13	14	13	14	13	13	
	24	Lifting (Laden)		mm/s	300	290		280		255			
	25	Lifting (Unladed)		mm/s	460	445		435		405			
	26	Gradeability	Laden	%	15								
	27		Unladed	%	15								
	28	Service weight	Include battery box	kg	2820	3080		3140		3430			
	29	Tyre	Front×2		18×7-8		18×7-8		18×7-8		200/50-10		
	30		Rear×2		15×4.5-8								
	Driven	31	Motor	Driven motor×2	kw	4×2	4.5×2	4×2	4.5×2	4×2	4.5×2	4×2	4.5×2
32		Pump motor		kw	9.2	12	9.2	12	11	12	11	12	
33		Battery	Standard (Option)	V/Ah	48/400 (500)		48/500 (500)		48/600 (625)				
34		Controller	Type		AC								
35			Manufacturer		ZAPI / Danaher Motion								
36		Operating pressure for attachment	Mpa	14.5									

Load Chart

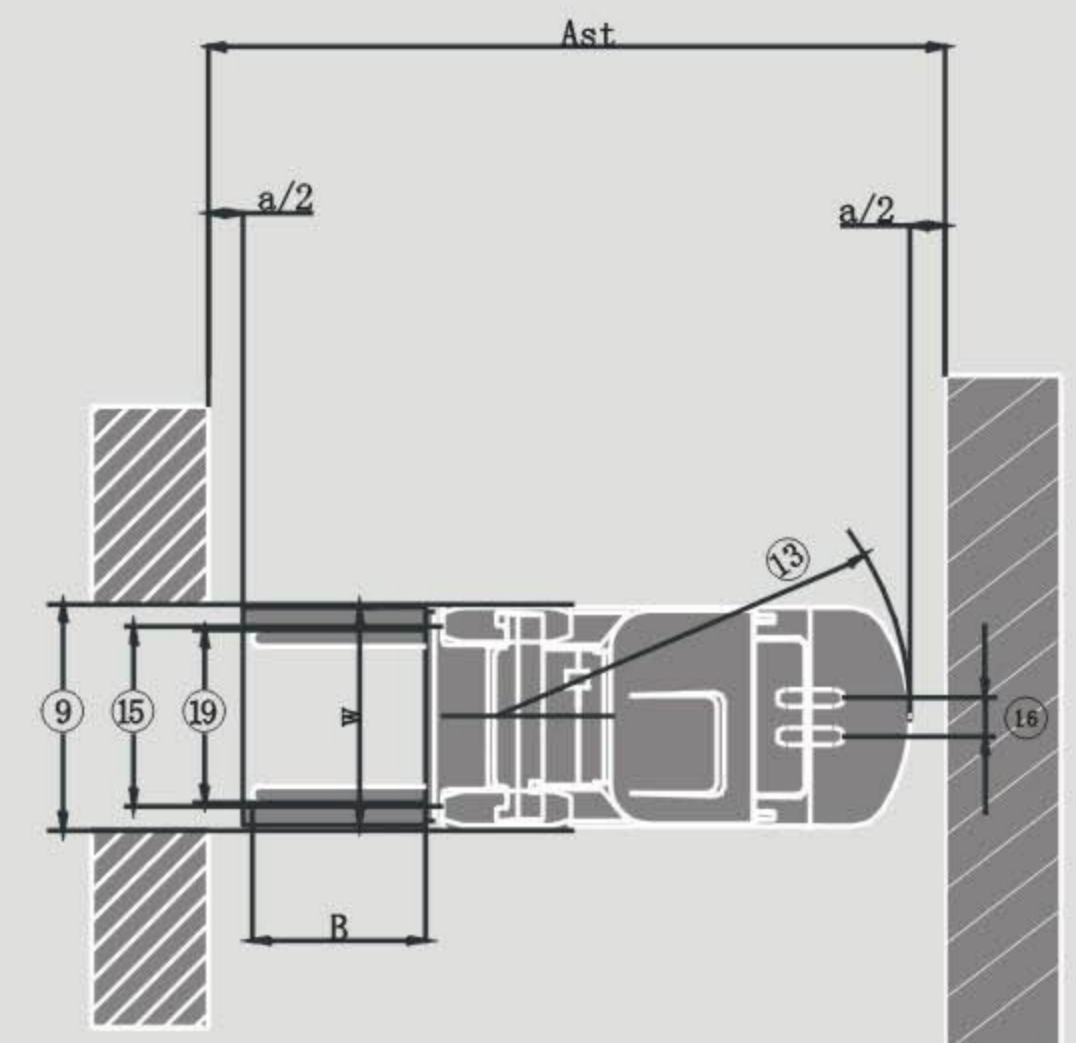
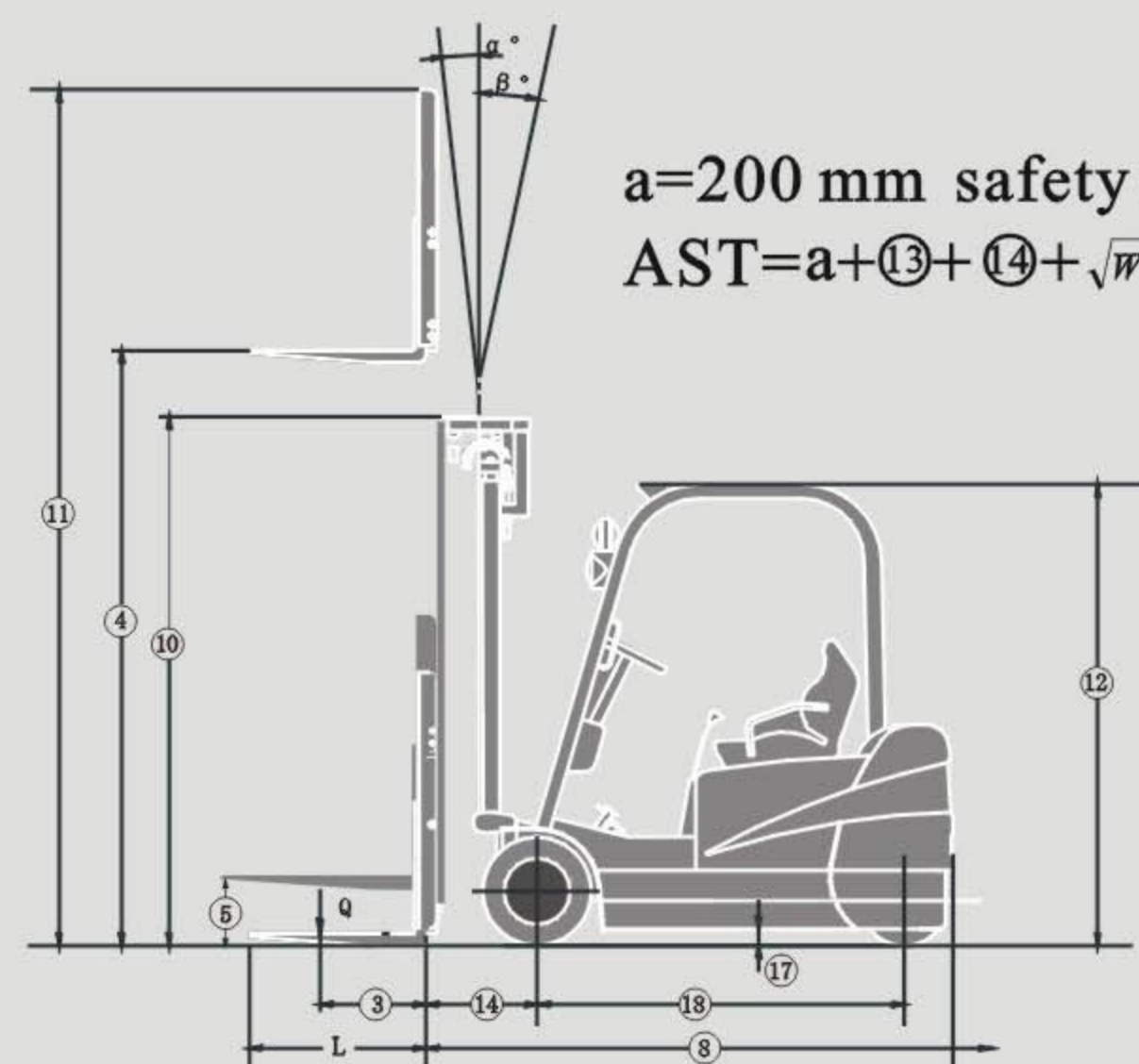
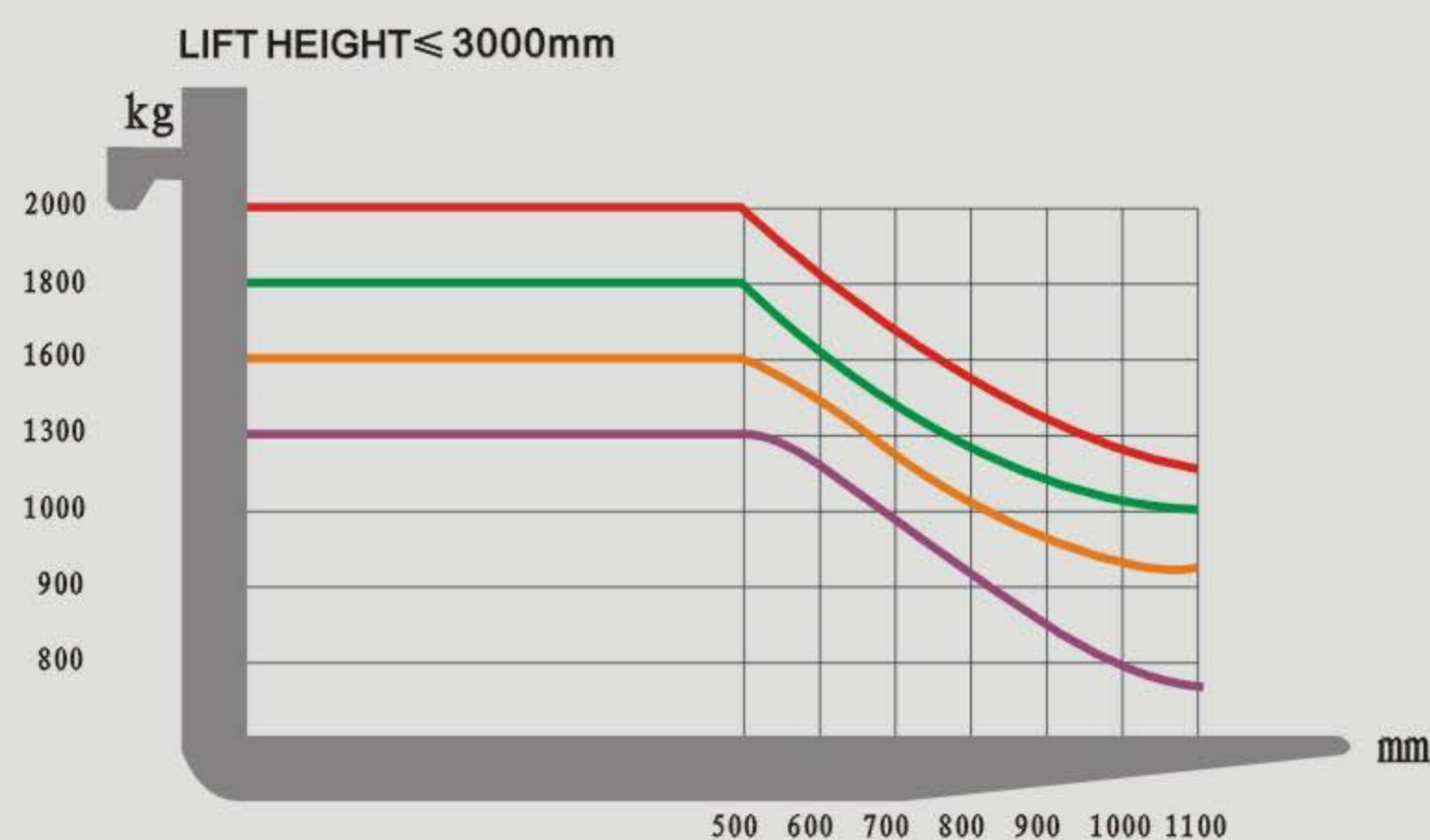

Sino-American Zhejiang Maximal Forklift Co., Ltd.  
 Address: No.1, Jinxin Road, Lushan Industrial area, Fuyang, Zhejiang China

Tel: 0086-571-28001566 28935028 28935029

Fax: 0086-571-28001569

Website: www.maxforklift.com

E-mail: info@maxforklift.com

All rights reserved. Any doubt, please contact us.



CE CERTIFICATE

ISO14001:2004

ISO9001:2000